

ECONOLEV LMG100

Magnetic level gauge

K-TEK products

Measurement made easy



The ECONOLEV LMG100 is a magnetic liquid level gauge specifically designed for the OEM / commercial storage tank, and light industrial market. It is engineered to meet most liquid measurement applications where a simple, non custom armored level gauge is required. The ECONOLEV provides an economical solution to traditional exposed glass level gauges.

Features

- Standardized design configuration for simple selection
- Low cost
- 2 in. (50.8 mm) schedule 40, 316SS pipe chamber
- Gauge rated to 13.7 bar (275 psi) (150# flange rating) and 93.3 °C (200 °F)
- Threaded top and bottom gauge and cap design allows easy maintenance
- Clear sealed Lexan tube for shuttle indicator
- Welded, side connected, 1in. NPT-f process connections
- 1/2 in. NPT-f vent and drain connection with plug
- Stainless steel scale indication

Options

- 316SS Threaded end caps (Standard is Carbon Steel)
- Magnetically actuated level switches
- Magnetostrictive level transmitter

Applications

- Diesel Storage tanks
- OEM tanks
- Water Treatment tanks
- Agricultural chemicals
- Most liquid tanks

SPECIFICATIONS

Material of Construction:	
Chamber	2 in. schedule 40 pipe, 316SS, maximum measuring length 15 ft. (180 in., 4572 mm) Threaded NPT, top and bottom. Threaded end caps, carbon steel, painted to prevent external corrosion. 1/2 in. NPT-f vent and drain connections.
Float	1-7/8 in. (47.62 mm) diameter 316SS .80 ... 1.0 specific gravity rated to 18.9 bar (275 psi) @ 93.3 °C (200 °F)
Local Indication	316SS scale and channel, clear, sealed Lexan tube with orange magnetic shuttle indicator
Process Connections	welded 1 in. NPT-f half coupling, 316SS (side connected)

ORDERING INFORMATION

Model Number Configuration

LMG100.a.b.c. Gauge measure length (in inches or millimeters)

a. End Cap Material

C1 - Carbon Steel (STD) with Carbon Steel 1/2 in. NPT plug

S6 - 316 Stainless Steel with Stainless 1/2 in. NPT plug

b. Indicator Scale / Ruler

A1 - feet / inches

A2 - meter / centimeters

c. Specific Gravity Range of Liquid for Float

F1 - 0.8 ... 0.89 (note: potential error of 7/8 in. (22.22 mm) throughout range)

F2 - 0.9 ... 1.0 (note: potential error of 7/8 in. (22.22 mm) throughout range)

Options: Switches: MS30, MS30EX, MS40, MS40EX (See switch datasheet)

Transmitter: AT600 4 ... 20mA output (see transmitter datasheet)

Additional ordering information

NOTE: Gauge measured length (to be specified in inches or millimeters only)

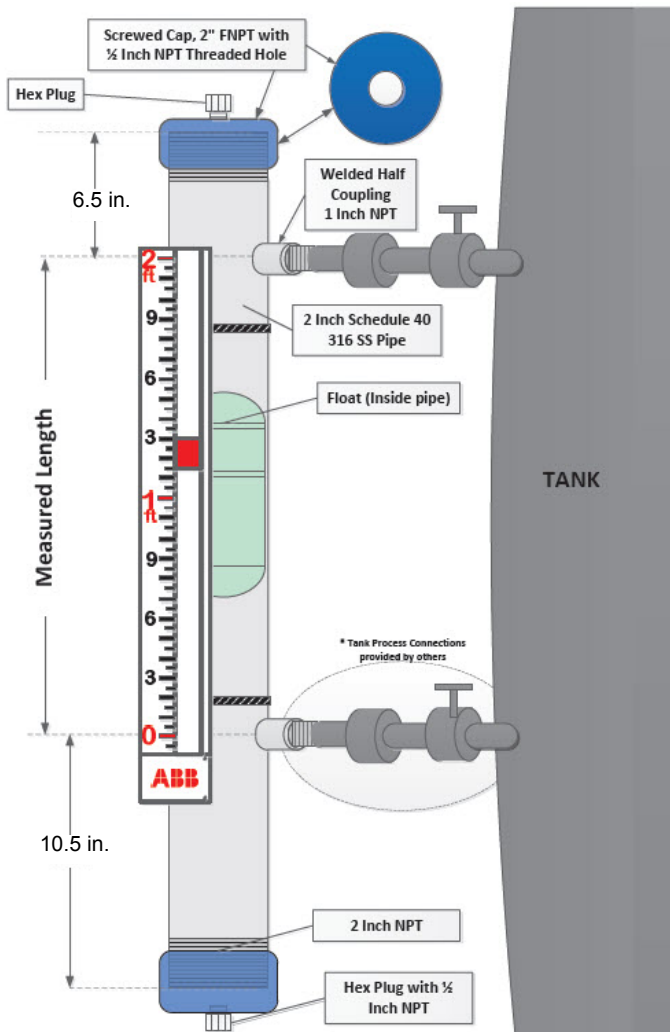

For more information, please contact:

ABB US

18321 Swamp Road
Prairieville, LA 70769

USA

Tel: +1 225 673 6100

Fax: +1 225 637 2525

www.abb.com/level

Note

We reserve the right to make technical changes or modify the contents of this document without prior notice. With regard to purchase orders, the agreed particulars shall prevail. ABB does not accept any responsibility whatsoever for potential errors or possible lack of information in this document.

We reserve all rights in this document and in the subject matter and illustrations contained therein. Any reproduction, disclosure to third parties or utilization of its contents - in whole or in parts - is forbidden without prior written consent of ABB.

Copyright© 2013 ABB
All rights reserved

3KXL111001R1011

SEITA

Soluciones en Instrumentación,
Automatización y Control Industrial

www.seita.com.co

Power and productivity
for a better world™

